

GENTLE GROWTH

CHILD CARE & SUPPORT



KARLY LINDSAY

Context

The purpose and end goal of Gentle Growth is to make the challenges of raising a new human easier. By providing multiple resources and having them all in one building, only separated by a flight of stairs or elevator ride. The provided spaces with Gentle Growth are Pediatricians, Therapy offices offering speech, art, and physical therapy for the children, regular and art therapy for the parents, as well as family counselling is provided. There are parent resources available which include, Post Partum and Prenatal support, both emotional and physical. Learning opportunities for new parents, Community connections, and a Nursing Area for mothers. Then there is a Baby Boutique and coffee shop as one and of course, two daycares with indoor playgrounds attached.

Design Intent

When choosing a space to develop, I thought about what was a pressing matter in my life right now, and I settled on a childcare and support centre. I have an eight-month-old Nephew, and he is my world, but seeing how my sister and her family are navigating this new lifestyle it brought new issues to light. Did you know that the UN estimates about 385,000 babies are born each day? That is 140 million new lives joining us on this planet a year. Out of that total 180 of those babies were born in Penitcion as of September 1st. However, in Penitcion there are only about 20 licensed daycares and none of them are currently taking new children. The waiting lists are even up to three years long. With a population close to 50,000 and an annual growth rate of 1.3% (As of 2023) it would be in the city's best interest to develop more daycares. This is where I found the need for my project. The anticipated outcome that I predict by providing such a space is that with exceptional design, anyone who enters the space will have a positive impact on them. Children will have somewhere to go that will indulge them with design aspects to help with their developing minds as well as simply entertain them, and the parents will have a space to help their little ones, help themselves, or find the resources they need.

Parti/Inspiration

The main driving inspiration for Gentle Growth is an oyster and a Pearl. Pearls are one of the seas and ocean's most unique treasures. They can come in different colors, shapes and sizes. As well as they take months to grow before they are ready to make their appearance. In more ways than none, this process is similar to growing your own children. The inspiration of the parti was from the idea of how a pearl came to be. How long it took, which can be quite similar to pregnancy, to the idea that an oyster is growing something so valued within itself. This has been incorporated in the floor plans by curving walls and feature areas like a Pearl. The colour palette has also been derived from natural Pearl colours.

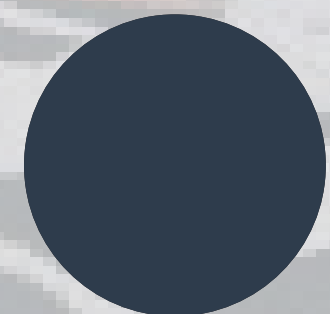

Sherwin-Williams
6244 Naval



Sherwin-Williams
7561 Lemon Meringue

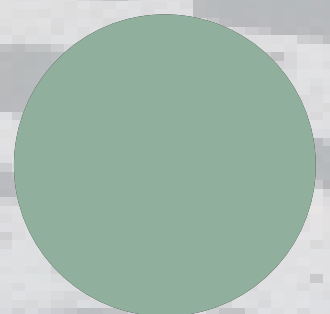

Sherwin-Williams
6458 Restful

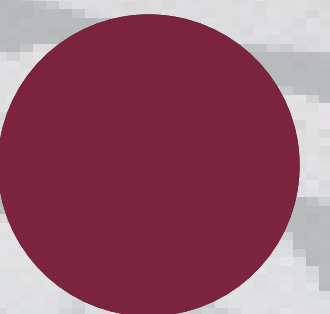

Sherwin-Williams
2902 Elderberry



Bordigon Lido Quartz
Vicenza



Interface LVT Flooring
Beech



Interface LVT Flooring
Washed Maple



Bordigon Lido Quartz
Statuario



Level 5

This level is accessible by Vancouver Avenue as the main gate entrance marked on the plan with the blue dot, is ground level. So, when you first come through the entrance gate you have one of two options, you can either go to the daycare reception or the cafe/boutique. In the reception area we have an area for staff to work, as well as the director's office, a photocopy room, a washroom for anyone, and most importantly the first aid room. Next as mentioned as the other option is the cafe/boutique. This is a small get-away for the parents to catch up with friends and have a cup of coffee, or maybe they need to buy something small for their little ones. After that are the daycares. They are laid out the same with minor differences. The top one is for the 1 year old to 30 months and is on the smaller scale. Then below is the daycare for the 3 to 5 year olds which has a bit more room for the children to run around in. Both daycares have their own indoor playgrounds in case it's rainy, or snowing, or just not all that pleasant outside. However, if it is all sunshine outside then there is the lovely outdoor playground for them. Then lastly for this level we have the staff area. This is fully equipped for anything they may need. A kitchen, working stations, a washroom with laundry and a shower, and of course a small lounge area.

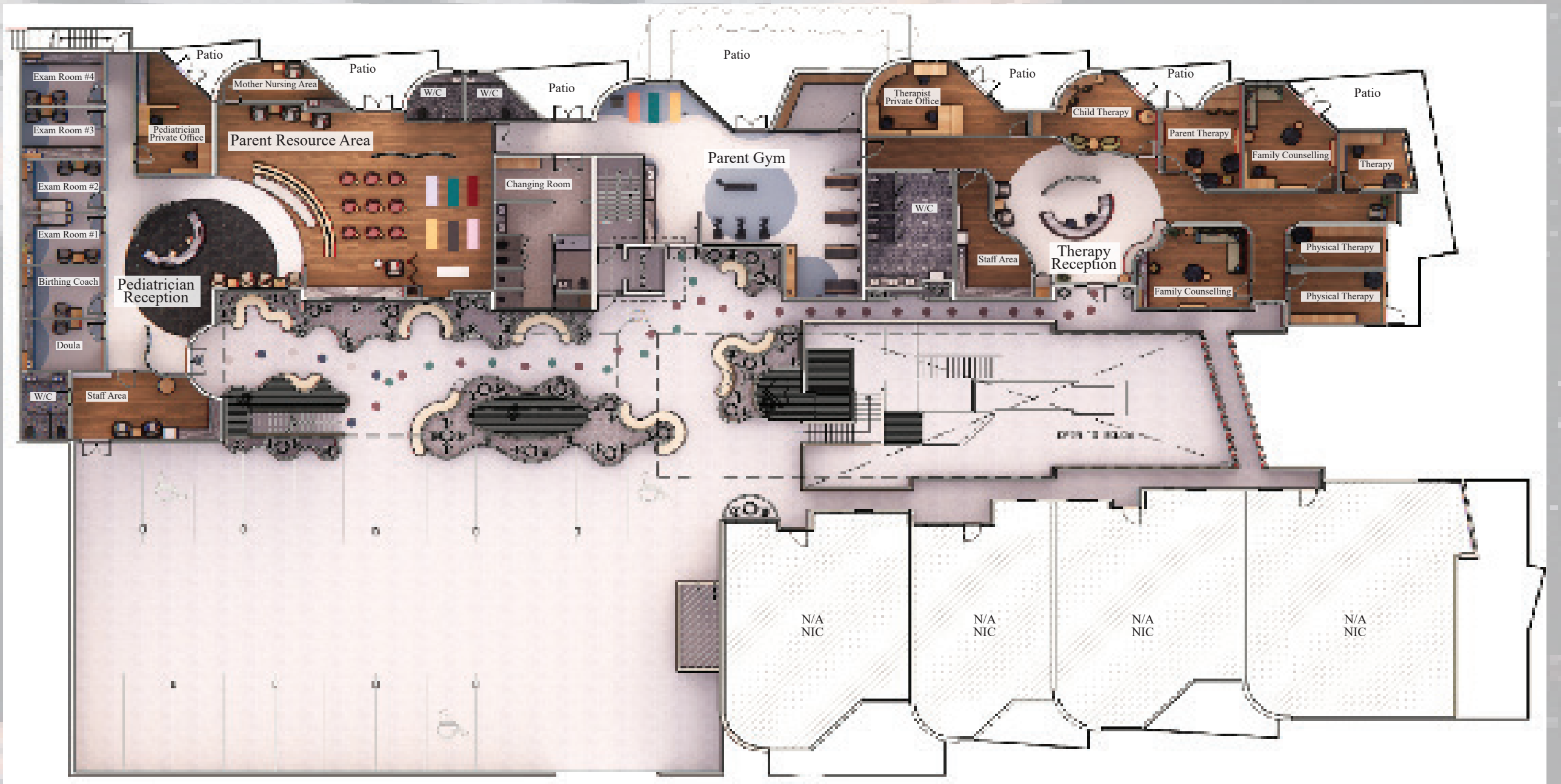

Level 4

This level is accessible by multiple flights of stairs and an elevator as well as that parking garage you can see in the bottom chunk. The first main area is the pediatrician office which is designated to the left side of the plan. This is equipped with a doula, birthing coach, four exam rooms, and a nutritionist. This space also has its own tiny staff area, and the pediatricians have their own private working office. This area also shares a reception desk with the parent resource area. The parent resource area has a multitude of workshops and flex space, right now on the plan you can see that it is set up for a learning class and a yoga lesson, between these two learning areas there is an operable wall to provide privacy or given the chance to make a bigger learning opportunity. Within the space there is also a parent information board where anyone in the town or community can come and post any parent information that might help or intrigue someone. The space also has a nursing area which is located up on the top side of the space for any mothers who may need it. Connected to this space is the parent gym which has its own changing room. The gym provides only a small amount of equipment as this isn't a heavy exercise area it's really just a space for the parents to come in and maybe release some stress or just want to waste time as their child is in daycare. Then the last space on this level is the therapy opportunities. Starting at the reception desk in the middle, to the left of that is their staff area, then a large washroom, above that is a private office for the therapists to work. Beside that is the child therapy, then the parent therapy, two family counseling rooms, then a spare regular therapy office used for anybody, lastly below that are two physical therapy offices.



Reception



3-5 year old Daycare



Pediatrician Reception



3-5 year old Nap Room



Child Therapy Room



Parent Therapy Room

CENTRE FOR ARTS AND TECHNOLOGY